

# D300 INTERNAL AND EXTERNAL CORNER DETAIL

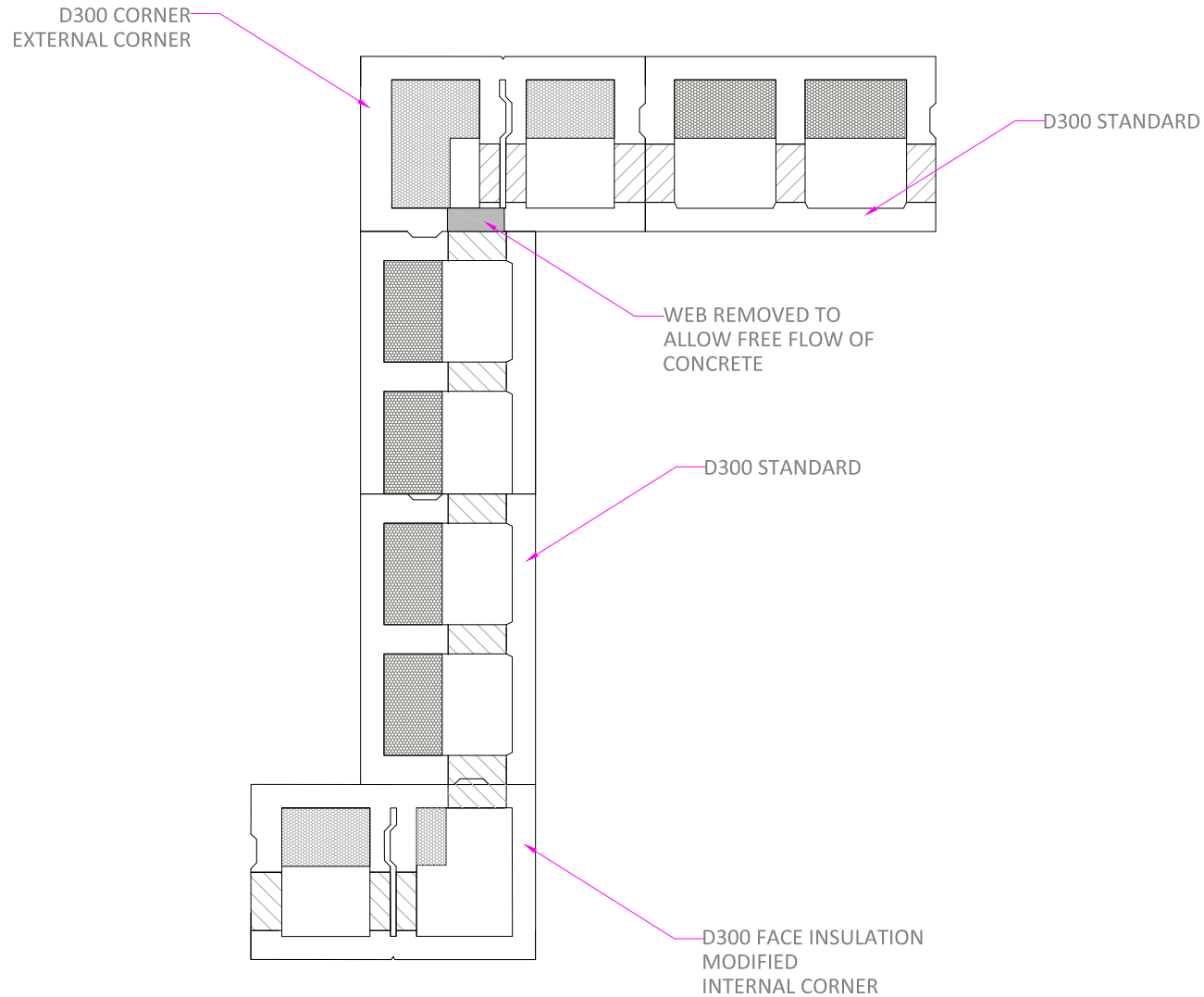

Durisol UK Ltd  
Parkway, Pen-y-Fan Industrial Estate,  
Crumlin, Gwent, NP11 3EF United Kingdom  
T 01495 249 400  
E [enquiries@durisoluk.com](mailto:enquiries@durisoluk.com)  
[www.durisoluk.com](http://www.durisoluk.com)

## DURISOL TECHNICAL RESOURCES

DRAWING NUMBER: DTP019

REV: 1

NOT TO SCALE

FOR INFORMATION ONLY. ALWAYS USE A STRUCTURAL ENGINEER FOR YOUR SPECIFIC PROJECT DETAILS