

D300 CORNER DETAIL

Cut this block to 450mm long to maintain half bonding of wall

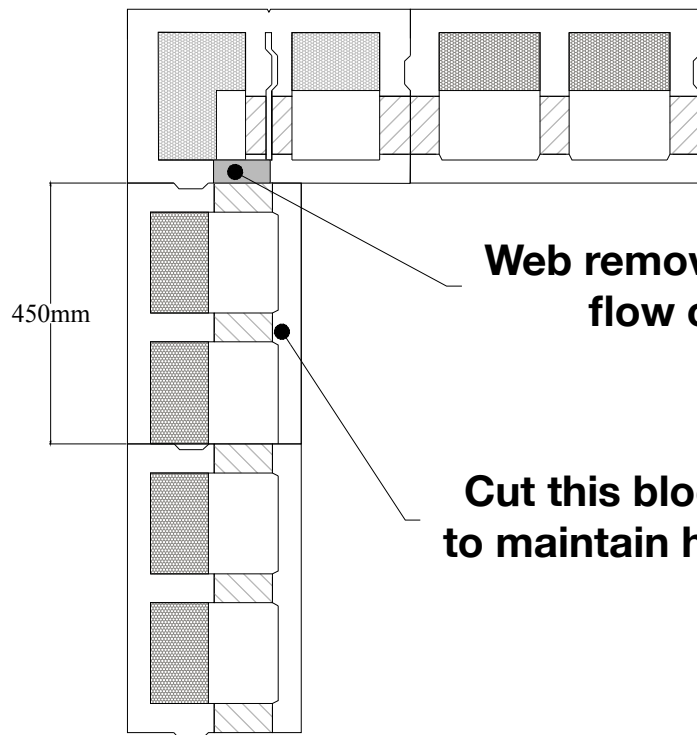

Web removed to allow free flow of concrete

Cut this block to 450mm long to maintain half bonding of wall

FIRST COURSE

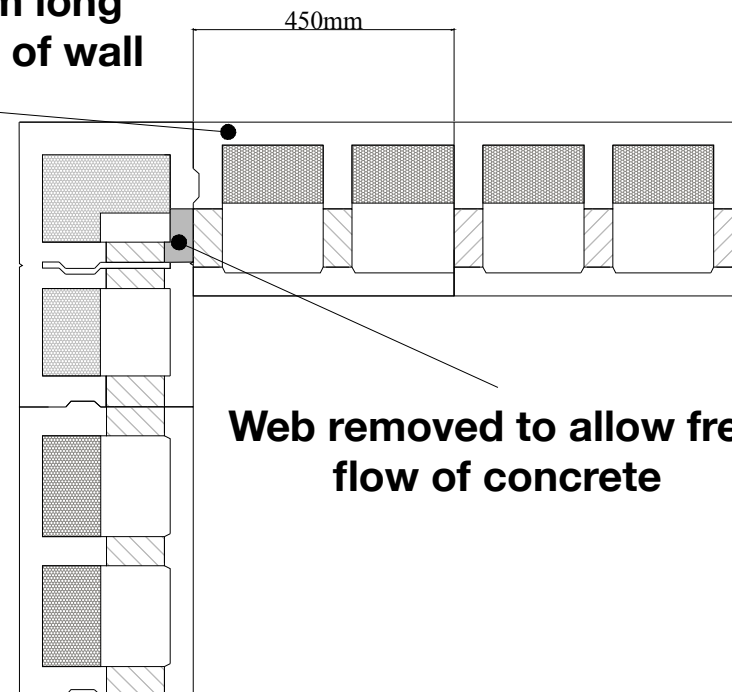

Web removed to allow free flow of concrete

SECOND COURSE



THE ORIGINAL ICF SYSTEM

www.durisoluk.com

Telephone: 01495 249 400

Email: enquiries@durisoluk.com

DURISOL UK

Parkway, Pen-y-Fan Industrial Estate,
Crumlin, Gwent, NP11 3EF

DURISOL TECHNICAL RESOURCES

DRAWING NUMBER: DTP012

REV:

NOT TO SCALE

FOR INFORMATION ONLY. ALWAYS USE A STRUCTURAL ENGINEER FOR YOUR SPECIFIC PROJECT DETAILS